

Oxford Root SEAL



Directions for Use

Dual Cure Self Etching Root Canal Sealing Material

Oxford Root SEAL is a simple to use self-etching dual cure sealer for conditioning of root canals and for sealing of side tubuli. Oxford Root SEAL consists of two components in a SingleMix unit that were mixed before application.

Contraindications

Do not use Oxford Root SEAL if the recommended working technique is not possible or if the patient is known to be allergic to any of the ingredients.

Side effects

In singular cases, Oxford Root SEAL may cause a sensitizing reaction in patients with a hypersensitivity to any of the ingredients. In these cases, the material should not be used. Irritations resulting from direct contact with the pulp cannot be ruled out. Therefore for pulp protection the cavity floor in cases of deep excavations should be covered with a thin layer of calcium hydroxide material.

Incompatibility with Other Materials

Do not use in combination with substances containing eugenol because eugenol inhibits the polymerization of Oxford Root SEAL. Neither store the material in proximity of eugenol containing products, nor let the material allow coming into contact with materials containing eugenol.

1. Preparation of the Root Canal

Prepare the root canal mechanically. Use of Oxford Root PREP in combination with sodium hypochlorite solution (NaOCl) gives excellent results.

Clean and disinfect the root canal using an antibacterial agent (e.g. natrium hypochlorite NaOCl). Thoroughly rinse the antibacterial solution from the root canal with EDTA solution or bacteria-free water before application of Oxford Root FILL. Best method for disinfecting is the photo-activated disinfection (PAD) e.g. Aseptim.

Note:

Do not use any lubricant or irrigants that are not specifically designed for endodontic use.

Remove excess liquid with dry paper points but do not desiccate the root canal.

2. Application of Oxford Root SEAL

To achieve an optimal obturation, apply the self etching dual cure sealer Oxford Root SEAL to the prepared root canal.

Activation of the SingleMix unit:

Pierce the supplied microbrush **vertical** through the aluminium foils of the SingleMix unit up to the riffles of the microbrush.

Ensure that both aluminium foils are penetrated completely.

Then mix the two components for 10 seconds.

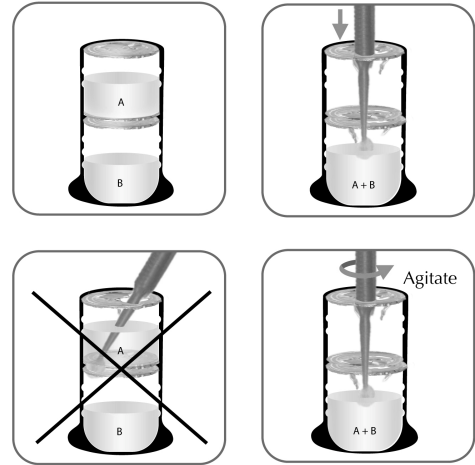

Apply the homogeneous mixture generously with the microbrush to the root canal walls for 10 seconds with agitation. Repeat procedure 1 – 2 times.

Remove excess sealer with dry paper points. Light cure all areas that are available for a dental curing unit for 20 seconds. Now Oxford Root FILL can be applied directly into the root canal (see directions for use Oxford Root FILL)

Warnings

- Unpolymerized material may have an irritating effect and may lead to a sensitizing reaction against methacrylates
- Avoid contact with skin, mucous membrane and eyes
- If the material comes into contact with skin, immediately wash with water and soap. If the material comes into contact with eyes, immediately rinse with copious amounts of water and seek medical advice if required.
- Commercial medical gloves do not protect against the sensitizing effect of methacrylates.

Storage

Do not store above 25 °C (77 °F)!

Avoid storage in direct sunlight.

Do not use after expiration date (see expiration date on label/packaging)

Oxford Root SEAL in SingleMix is for single use only.

Warranty

First Scientific Dental Materials GmbH warrants this product will be free from defects in material and manufacture. First Scientific Dental Materials makes no other warranties including any implied warranty of merchantability or fitness for a particular purpose. User is responsible for determining the suitability of the product for user's application. If this product is defective within the warranty period, your exclusively remedy and First Scientific Dental Materials' sole obligation shall be repair or replacement of the First Scientific Dental Materials product.

Limitation of Liability

Except where prohibited by law, First Scientific Dental Materials GmbH will not be liable for any loss or damage arising from this product, whether direct, indirect, special, incidental or consequential, regardless of the theory asserted, including warranty, contract, negligence or strict liability.

Keep away from children!

For dental use only!

Caution:

Federal law restricts the sale of this device to or by the order of a dentist.



Manufacturer:

First Scientific Dental Materials GmbH, 25335 Elmshorn, Germany

